

Attraction Type: Museum/gallery

Location: England

Opening Year: 2015

Budget: £8,000,000



Summary:

York Art Gallery have **ambitious plans** to make a 'must see' arts destination by **fully developing** the footprint of the existing 19th-century building. Spaces to be redeveloped include the '**secret gallery**' in the roof void of the main gallery as well as the spaces currently occupied by the **City Archives**. These new areas will allow for **expanded exhibition** and learning facilities. The plan also includes creating a **connection** with the **gardens** at the rear of the gallery, which will provide opportunities for **outdoor exhibitions** and performance. The project team is led by **Ushida Findlay** who worked on the Arcelor Mittal Orbit at the **Olympic Park**.

Contacts

York Art Gallery

Exhibition Square, York YO1 7EW

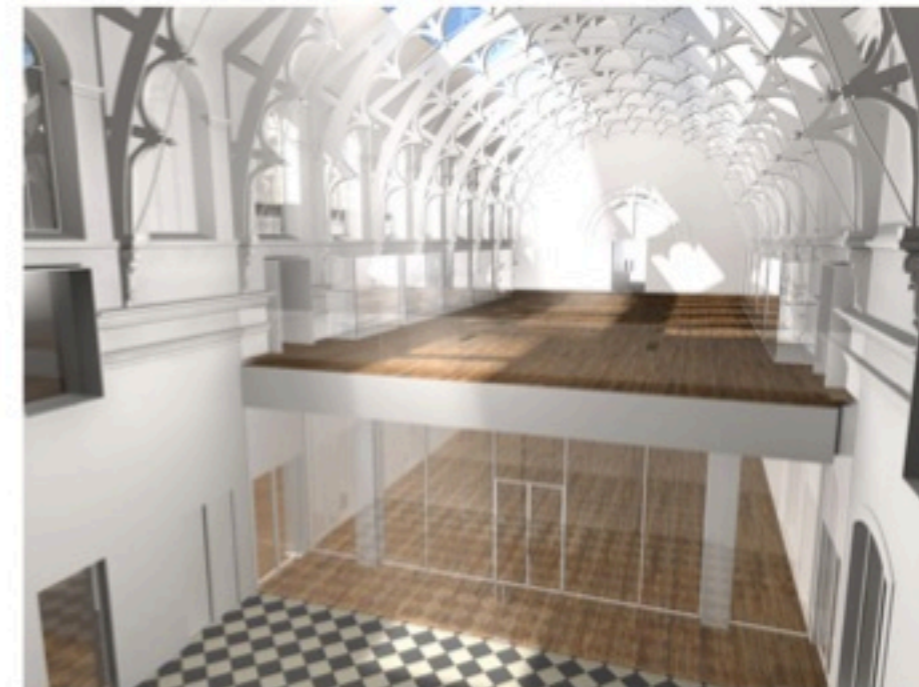

Janet Barnes, Chief Executive, York Museums Trust
T 01904 687 687

Lee Clark, Media Co-ordinator
T 01904 687 673
E lee.clark@ymt.org.uk

Lorna Sergeant, York Art Gallery Manager
E lorna.sergeant@ymt.org.uk

Ushida Findlay Architects
Carlow House, Carlow Street, London NW1 7LH
T 0207 755 6688

Simpson & Brown/Addyman Archaeology
St Ninian's Manse, Quayside Street, Edinburgh EH6 6EJ

Appleyard & Trew, Project Managers
Hornbeam House, Hornbeam Park, Hookstone Road, Harrogate
HG2 8QT
T 01423 871 471

Photo: Ushida Findlay Architects